

Dimension: (Unit: mm)

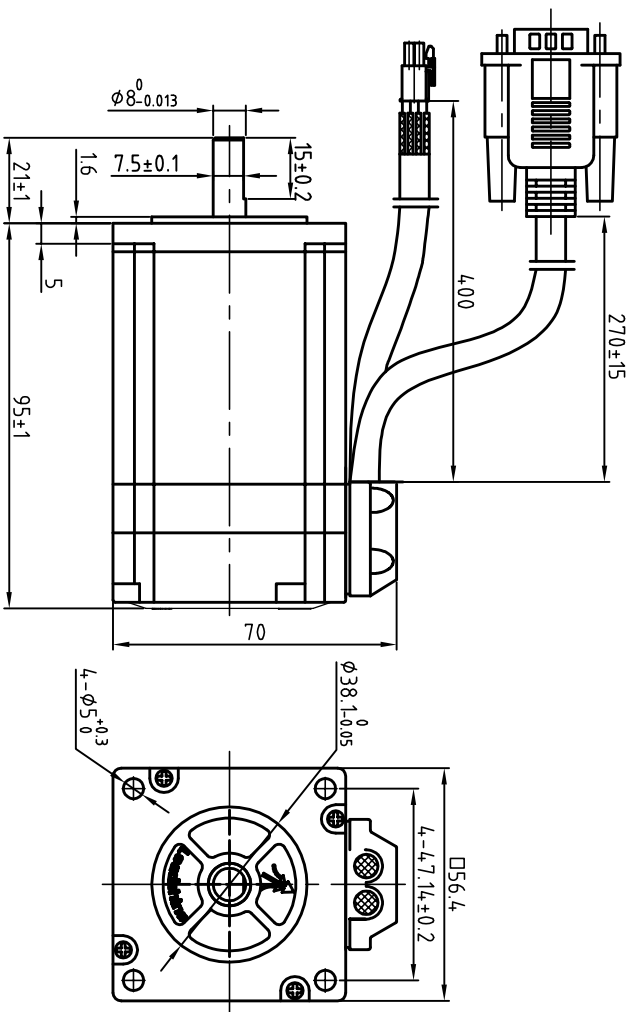

### Motor Connctions

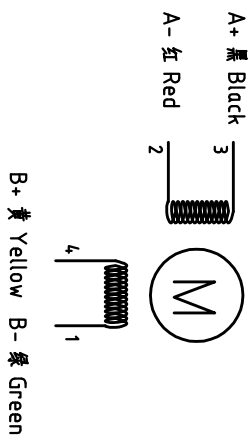
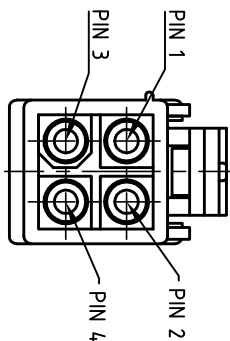

### Common Rating

Step angle	1.8°
Position accuracy	1.8±0.09°
Dielectric strength	500VAC 1min
Insulation resistance	100MΩhm(500VDC)
Insulation class	B
Temp rise(Max)	80K
Radial play	Max:0.02mm(load 4.50g)
Axial play	Max:0.08mm(load 900g)

### Specification:

Current/phase	5.0 A
Voltage	19 V
DC Resistance/phase ±10%	0.38 Ω
Inductance/phase ±20%	1.75mH
Holding torque	2.3 N·M
Inertia	0.48 kg·cm <sup>2</sup>
Weight	
Encoder resolution	1000 cpr

### Encoder Signals

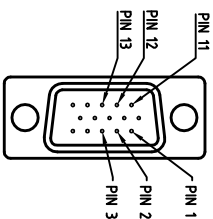

PIN	1	2	3	11	12	13
颜色	黑	红	白	黄	绿	蓝
定义	A+	VCC	GND	B+	B-	A-

设计 Designed	王洪焱	日期 Date	18.03.01	材料 Material	
审核 Checked	秦晖	18.03.01		第一角画法 First Angle projection	
批准 Approved	田天睦	18.03.01		重量 Weight	
图号 Part No.				比例 Scale	
				请标注 Stage Mark	
				共 1 套 第 1 套 Sheet 1 of 1	
				图号 DWG. NO.	LS-CM57-03-0011-01
				标题 Title	混合伺服电机
					57CME23-C
					深圳市雷赛智能控制股份有限公司 SHENZHEN LEADSHINE TECHNOLOGY CO., LTD.

版本 Rev	日期 Date	变更文件号 ECU NO.	变更内容 Revisions	设计 By
V1.0	18.03.01		增加安普头	王洪焱